



Photo: Lisa Combs

# Spring preschool child with adult classes

**Awaken your senses to the arrival of spring. Hike in the woods to see the vernal ponds and hear the spring peepers. Visit the farm and the newborn animals. See and smell the flowers. Signs of spring are all around SM&NC. Come to a class and make your own signs of spring. We'll use nature to inspire us!**

## Registration

Mon, March 1  
Family PLUS & above  
Mon, March 8  
Open registration

Photo: Lisa Combs



**All classes take place at the Heckscher Barn on the farm.**

### **Tiny Tots • 9:30 am–10:15 am**

**Age: 18–24 months | Instructor: Beth Strauss**

**EC1S** 8 weeks, Tuesdays, March 30–May 25 (No class April 13)  
**or EC2S** 8 weeks, Wednesdays, March 31–May 26 (No class April 14)

Our youngest artists will be given a chance to experiment with many different materials. Simple techniques will be explored. Your child will create his or her own “masterpiece” to take home.

**Members \$110 | Non-members \$130**

### **Pee Wee Picassos • 9:30 am–10:15 am**

**Age: Just 2 | Instructor: Pat Hutchison**

**EC3S** 8 weeks, Mondays, March 20–May 24 (No class April 12)

Our young two-year-olds love this opportunity to experiment with a variety of fun, squishy and colorful art materials.

**Members \$110 | Non-members \$130**

### **Terrific Toddlers • 9:30 am–10:15 am**

**Age: 2 | Instructor: Pat Hutchison**

**EC4S** 8 weeks, Thursdays, April 1–May 27 (No class April 15)

Explore and imagine through art. Adult and child will work together on age-appropriate art experiences and learn about the properties of various art materials.

**Members \$110 | Non-members \$130**

### **March into Spring • 10:30 am–11:15 am**

**Age: 2+ | Instructor: Beth Strauss**

**EC5S** 8 weeks, Tuesdays, March 30–May 25 (No class April 13)  
**or EC6S** 8 weeks, Wednesdays, March 31–May 26 (No class April 14)

March around SM&NC and see how spring has arrived. The earth is warming up and plants and animals are waking up from their winter rest. The farm is a busy place. Come back into the classroom and create something special to remember your outdoor adventure.

**Members \$110 | Non-members \$130**

### **Spring! • 10:30 am–11:15 am**

**Age: 2+ | Instructor: Pat Hutchison**

**EC7S** 8 weeks, Mondays, March 29–May 24 (No class April 12)  
**or EC8S** 8 weeks, Thursdays, April 1–May 27 (No class April 15)

Learn all about this beautiful season. Your child and you will create your own interpretation of what you see happening outside. Paper, paint, glue and other art materials will be used to make your unique spring creations.

**Members \$110 | Non-members \$130**



Photo: Lisa Combs

## Early childhood drop-off

### From Seed to Plant • 1:15 pm–3:15 pm

Ages: 4–5 | Instructor: Beth Strauss

**EC9S** 8 weeks, Tuesdays, March 30–May 25 (no class April 13)

There's a secret in every seed. Your child will discover the secret while investigating edible seeds and seeds for growing. In this season of new growth children will observe, plant, eat seeds, and, of course, use seeds for creating art treasures.

Members \$205 | Non-members \$225

### Creative Farms • 1:15 pm–3:15 pm

Ages: 4–5 | Instructor: Pat Hutchison

**EC10S** 8 weeks, Mondays, March 29–May 24 (No class April 12)

Students will see the farm animals and how they live on the Heckscher Farm. What do they eat? Where do they sleep? After our outdoor time we'll go back to the classroom and use art materials to create our own imaginative farms.

Members \$205 | Non-members \$225

## Junior Curator

Entering Grades 5–9 | Instructor: Heckscher Farm Staff

**3:30–5 pm FS13** April 12–16 | **FS14** May 3–7 | **Saturday Sessions, 10:30 am–12 pm FS15** May 1, 8, 15, 22 & 29

This unique program provides an overview of basic animal care and experiential learning on Heckscher Farm. The course includes a behind-the-scenes tour, lots of hands-on experiences and several independent farm projects. Upon completion, each child may be eligible to become a volunteer Junior Curator on Heckscher Farm.

Meets at Heckscher Farm, *rain or shine*

Weekday programs: Members \$70 | Non-members \$100 / Saturday sessions: Members \$100 | Non-members \$130

## GENERAL INFORMATION... About Spring Classes

### Registration

Family PLUS & above Members:

Monday, March 1

Open Registration: March 8

For Membership information,  
call 203.322.1646 x6533

**Register early** as classes fill up quickly! Please include class code and numbers when registering (example: EC11S).

- Registrations are accepted on a first-come, first-served basis.
- Registration form must be accompanied by payment in full.
- Registration closes one week prior to program start date.
- No phone registrations.
- Fax registrations will be handled as mail-in registrations.
- **We do not send confirmations.** Registrants are notified if classes are cancelled or full.
- Children must have reached the required age prior to the first class of a session.
- No guests or pets allowed.

### Class Schedules

Based on the Stamford Public School Calendar, some classes will not be held the week of April 12–16 and May 31. Some programs may still be scheduled. Please read class listings carefully.

### Weather Related Closings

Please listen to radio station WSTC-1400 AM for cancellation of any class due to the weather. **If the Stamford Public Schools are closed, we will be closed. Make-up classes will be scheduled.** You may also call 203.322.1646 x6528 for cancellation information.

### Refunds

No refunds are given unless a class is cancelled by the Stamford Museum & Nature Center. Emergency situations will be considered at the Museum's discretion. Please register carefully!

### For more information call:

**203.322.1646:**

**x6521** Main Office

**x6528** Early Childhood Education  
(class code EC)

**x6529** Farm Office  
(class code F)

NOTE: From time to time Stamford Museum & Nature Center representatives photograph children during SM&NC classes, workshops and camps. These photos may be used on the SM&NC Web site, in brochures, newsletters, class catalogues, and accompanying press releases. If you do not want your child to be photographed, please send a letter to that effect, Attn: Photo Department.  
Thank you!

# Spring Classes 2010 Registration Form

- Checks payable to Stamford Museum & Nature Center
- Mark envelope "Registration"
- Mail to: Stamford Museum & Nature Center, 39 Scofieldtown Road, Stamford, CT 06903 or Fax to: 203.322.0408

**1st Parent's Name** Dr. | Mr. | Mrs. | Ms. | circle one

Name (last) (first) email

**2nd Parent's Name** Dr. | Mr. | Mrs. | Ms. | circle one

Name (last) (first) email

Address

City State Zip

Tel (home) (business)

Emergency Contact Name Tel

1st Child's Name

Date of Birth Age Entering Grade

Documented serious allergies

1. Class # Title Fee

2. Class # Title Fee

3. Class # Title Fee

2nd Child's Name

Date of Birth Age Entering Grade

Documented serious allergies

1. Class # Title Fee

2. Class # Title Fee

3. Class # Title Fee

Membership fee for *new members* and *renewals* must accompany this registration form.

\$ 80 Family

\$150 Family Plus

\$250 Patron

\$ 20 Nanny Card add-on

Please note: Replacement cards \$10 each

Total Class Fee

Membership Fee

**Total Amount Enclosed**

Name(s) to appear on membership cards, if applicable (2 maximum):

1

2

**Check one:**  Current Member  New Membership  Renewal Membership  Non-Member

**Method of Payment:**  MasterCard  Visa  AmEx  Cash (in person only)  Check (make checks payable to Stamford Museum & Nature Center)

Credit Card  Mastercard  Visa  Amex

Acct No. Name (as it appears on card)

Exp Date CVW Code Signature

Billing Address: Street City State Zip



## Stamford Museum & Nature Center

39 Scofieldtown Road, Stamford, CT 06903

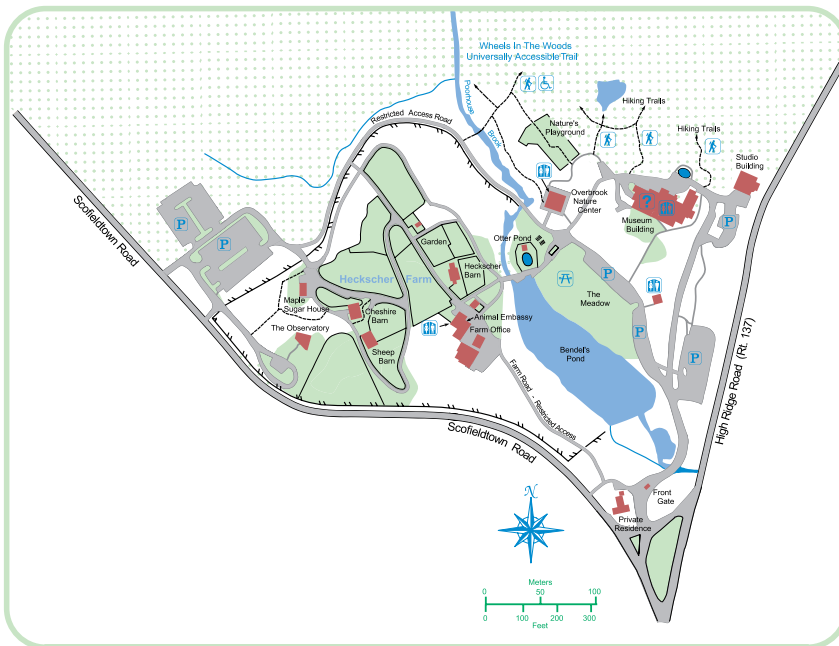

### HOURS

#### Heckescher Farm

9 am to 5 pm (April–October)

#### Nature's Playground

Daily 9 am to 5 pm (weather permitting)

#### Bendel Mansion & Galleries

Mon – Sat, 9 am to 5 pm

Sunday, 11 am to 5 pm

#### Animal Embassy

Tues – Sun, 10 am to 3:30 pm

### Admission Fees

**SM&NC members** free; special discounts  
at Family Festival Days

**Stamford residents** free on Wed

**Adults** \$8; **Seniors** (65+) \$6

**Students** (18+) \$6

**Children** (4–17) \$4; (3 & under) FREE

**Planetarium Show** Members FREE!

Second Sunday each month, 3 pm  
\$3 Adults; \$2 Children 5 & older

**Observatory** Members FREE!

Non-Members: Adults \$3;

Children (5–17) \$2

Fri 8:30 to 10:30 pm

### Membership Information:

203.322.1646 x6533

[stamfordmuseum.org](http://stamfordmuseum.org)

203.322.1646

*The Stamford Museum & Nature Center is a 501(c)(3) not-for-profit organization.*